

# 501

Bloor Street West

*Retail*

**FOR SUBLEASE**





501 BLOOR STREET WEST

# Property Details

<b>GROUND FLOOR:</b>	2,789 SF
<b>AVAILABLE:</b>	Immediately
<b>TERM:</b>	5-10 years
<b>NET RENT:</b>	Please Contact Listing Agents

## HIGHLIGHTS

- Premium, renovated space in the heart of The Annex
- Over 26 FT of frontage on the south side of Bloor Street West
- Steps from Bathurst Station and the massive Mirvish Village redevelopment site
- Incredible foot traffic and vehicular traffic





# Floor Plan

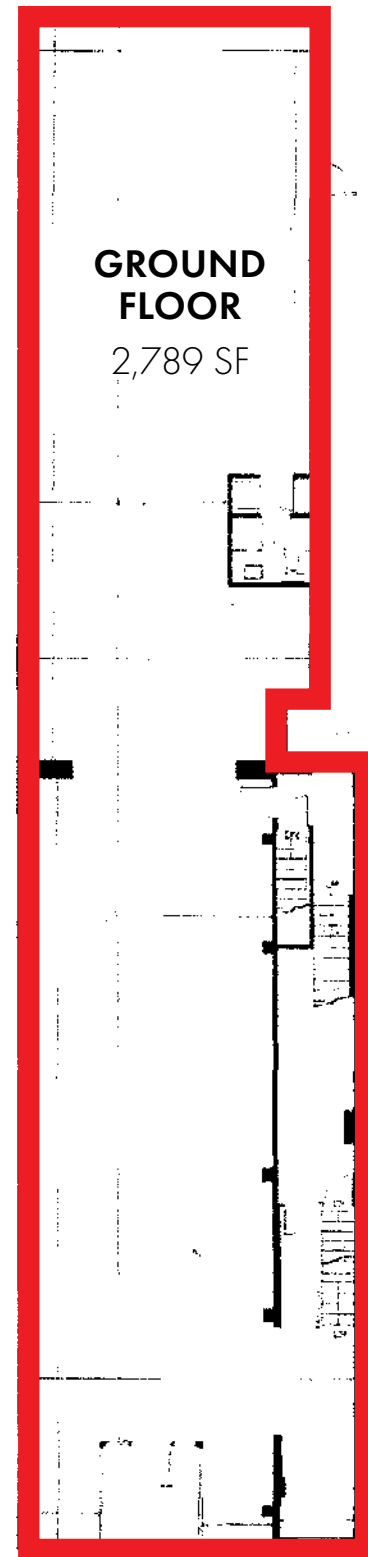

BLOOR STREET WEST



# Neighbourhood Retailers

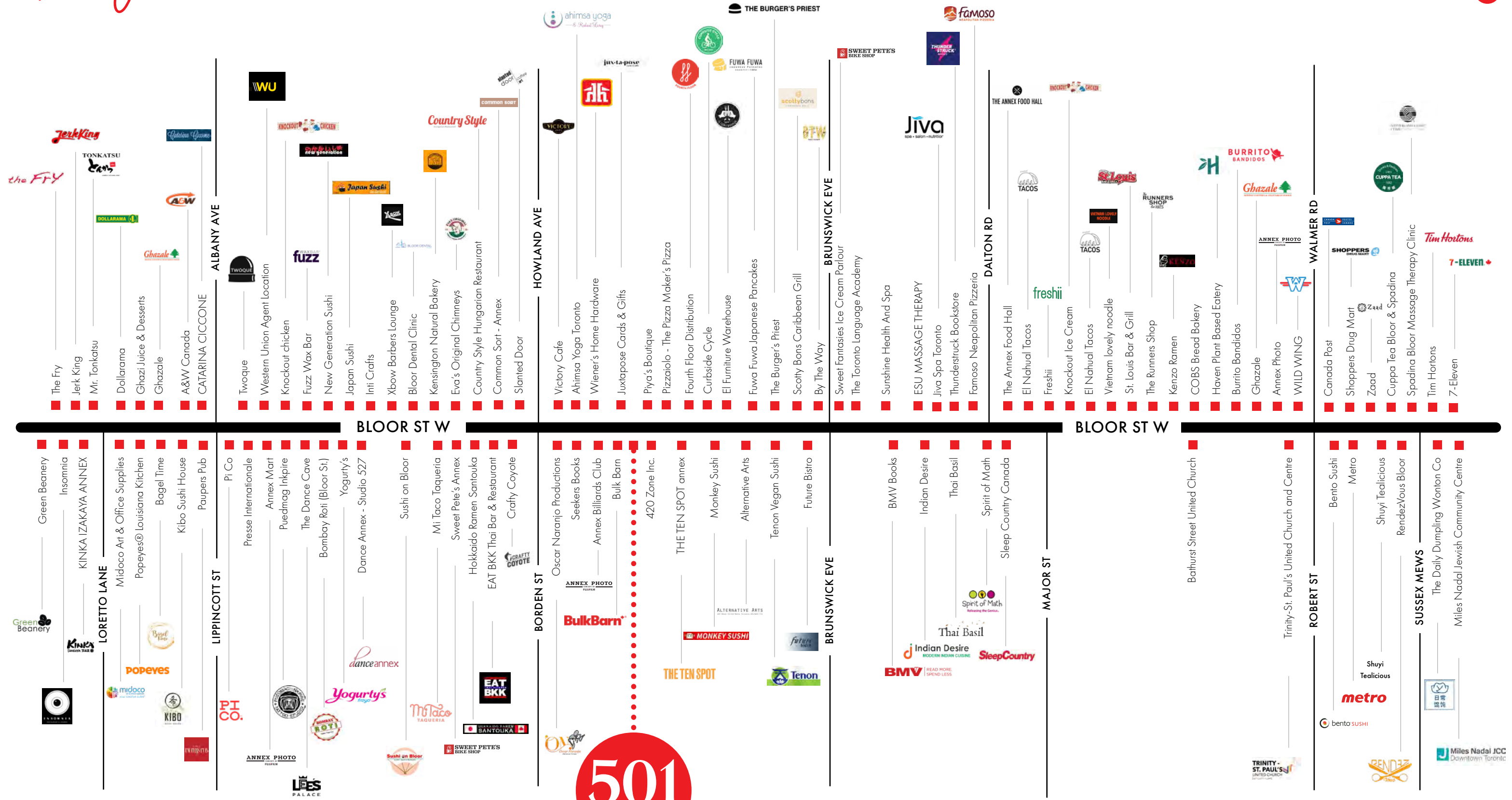

**501**  
Bloor Street West





# Location Overview

501 Bloor Street West is located within the boundaries of three major traffic arterial routes, Bloor Street West, Spadina Avenue, and Bathurst Street, with an average over 24,000 vehicles passing the property each day. In addition to the impressive vehicular traffic, 501 Bloor Street West benefits from substantial pedestrian traffic in the heart of The Annex.

This location benefits from high-speed, city-wide public transit services at its doorstep, ideally positioned 350 metres from both TTC's Bathurst Station and Spadina Station, which provides direct access to the Bloor-Danforth subway line, the main arterial traversing east-west across the City of Toronto, whilst providing connecting services to main transit terminals such as Yonge & Bloor and Union Stations.

 **8,188**  
Total Population

 **8,755**  
Daytime Population

 **\$126,267**  
Average Household Income

 **\$132,914**  
Average Household Spending

 **1%**  
Growth Rate (2016-2021)

 **33.9**  
Median Age

 **97**  
Walk Score

 **100**  
Transit Score

Within 1km Radius | Statistics Canada, 2022





# 501

Bloor Street West

*Retail*

## FOR SUBLEASE

### AGENCY RETAIL GROUP

#### BRANDON GORMAN\*\*

Senior Vice President  
+1 416 855 0907  
Brandon.Gorman@am.jll.com

#### GRAHAM SMITH\*

Senior Vice President  
+1 416 855 0914  
Graham.Smith@am.jll.com

#### MATTHEW MARSHALL\*

Sales Associate  
+1 416 238 9925  
Matthew.Marshall@am.jll.com

Although information has been obtained from sources deemed reliable, neither Owner nor JLL makes any guarantees, warranties or representations, express or implied, as to the completeness or accuracy as to the information contained herein. Any projections, opinions, assumptions or estimates used are for example only. There may be differences between projected and actual results, and those differences may be material. The Property may be withdrawn without notice. Neither Owner nor JLL accepts any liability for any loss or damage suffered by any party resulting from reliance on this information. If the recipient of this information has signed a confidentiality agreement regarding this matter, this information is subject to the terms of that agreement. ©2022 Jones Lang LaSalle IP, Inc. All rights reserved. \*\*Broker. \*Sales Representative.